

POD

Pneumatically operated drain

PRODUCT FEATURES

The POD removes condensate from compressed air systems.

The operation is automatic and there is no unnecessary compressed air lost during the condensate discharge cycle.

The POD uses pneumatic forces to operate the valve assembly and is ideally suited in applications where power is not available, too expensive or not reliable.

The large orifice, combined with the large discharge capacity make this drain suitable for all compressor capacities.

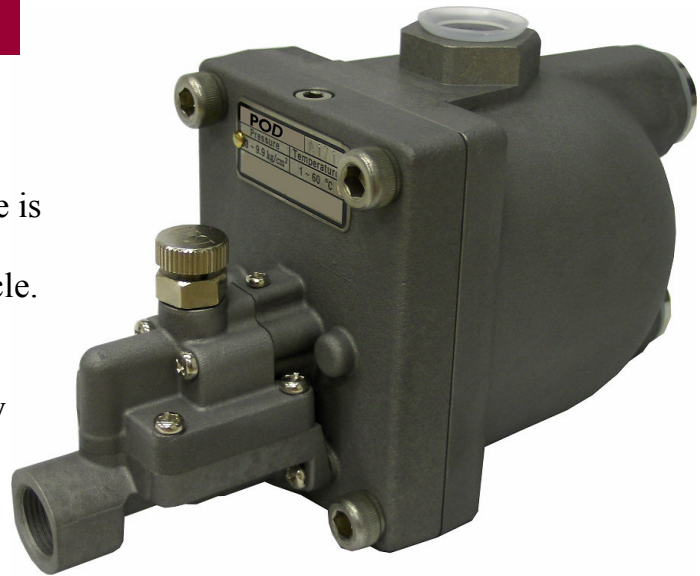

COMMERCIAL BENEFITS

- Condensate discharge without unnecessary air loss.
- No electricity required to operate the drain.
- Pneumatically operated.
- Condensate discharge of any type of compressed air system.
- Operating pressure up to 230 PSI.
- Robust aluminum housing.

TECHNICAL ADVANTAGES

- Simple installation.
- No control air line required!
- Top and side inlets available.
- TEST feature
- Heater Option

No electricity
required.

Large discharge
capacity!

WARNING

Failure to carry out regular routine draining can have catastrophic results. Compressed air systems can become contaminated and production schedules can get seriously disrupted – just because a simple duty has been neglected.

POD[®]

Pneumatically operated demand condensate drain

DIMENSIONS 1/2" & 3/4" (25.1"=1 MM)

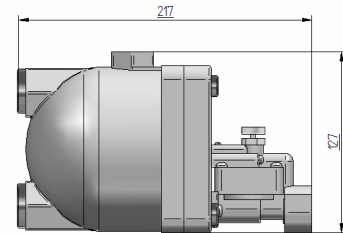
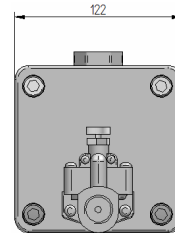
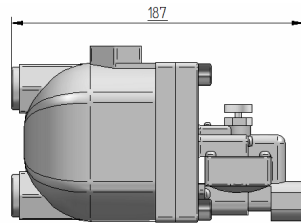
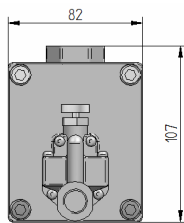

POD 1800 1/2"
Model

POD-4500 3/4"
Model

SPECIFICATIONS

POD 1800

Maximum compressor capacity	1800 CFM.
Inlet/outlet connection	1/2" inlet and 3/8" outlet
Valve orifice 1/2"	4.0 mm
Minimum/maximum system pressure	2 PSI/230 PSI (depending on selected model)
Minimum medium temperature	34° F
Maximum medium temperature	122° F
Serviceable valve	Yes
Valve seals	Viton (FPM)
Housing material	Aluminium

POD 4500

Maximum compressor capacity	4589 CFM.
Inlet/outlet connection	3/4" inlet and 1/2" outlet
Valve orifice 3/4"	7.0 mm
Minimum/maximum system pressure	2 PSI/230 PSI (depending on selected model)
Minimum medium temperature	34° F
Maximum medium temperature	122° F
Serviceable valve	Yes
Valve seals	Viton (FPM)
Housing material	Aluminium

JORC is ISO 9001:2000 Certified

Information provided herewith is believed to be accurate and reliable. However, no responsibility is assumed for its use or for any infringement of patents or rights of others, which may result from its use. In addition, JORC reserves the right to revise information without notice and without incurring any obligation.

JORC Industrial LLC. Tel 302-395-0310
 1146 River Road Fax 302-395-0312
 New Castle, DE 19720 E-mail : info@jorc.com
[http:// www.jorc.com](http://www.jorc.com)